



SSC80A3GT8

P-Channel Enhancement Mode MOSFET

Features

V _{DS}	V _{GS}	R _{DS(ON)}	I _D
-100V	±20V	35mΩ@-10V	-35A
		40mΩ@-4V5	

Description

This device is P-Channel enhancement MOSFET. Uses advanced trench technology and design to provide excellent RDSON with low gate charge. This device is suitable for use in DC-DC conversion, power switch and charging circuit.

100% UIS + ΔVDS + Rg Tested!

Applications

- Motor Drive Control
- Portable Devices
- DCDC Conversion
- Power Supplies
- Synchronous Rectification

Ordering Information

Device	Package	Shipping
SSC80A3GT8	TO-252-2L	2500/Reel

Pin Configuration

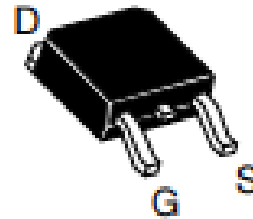

TO-252-2L (Top View)

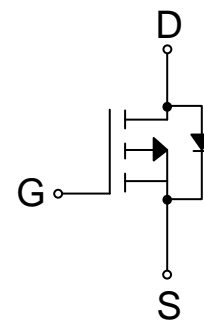

Pin Configuration

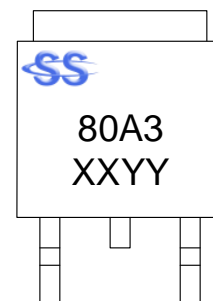

Marking

(XXYY: Internal Traceability Code)



➤ **Absolute Maximum Ratings ($T_A=25^\circ\text{C}$ unless otherwise noted)**

Symbol	Parameter	Ratings	Unit
V_{DSS}	Drain-to-Source Voltage	-100	V
V_{GSS}	Gate-to-Source Voltage	± 20	V
I_D	Continuous Drain Current ^d	$T_C=25^\circ\text{C}$	-35
		$T_C=100^\circ\text{C}$	-18
I_{DSM}	Continuous Drain Current ^a	$T_A=25^\circ\text{C}$	-7.5
		$T_A=70^\circ\text{C}$	-5.1
I_{DM}	Pulsed Drain Current ^b	-140	A
P_D	Power Dissipation ^c	$T_C=25^\circ\text{C}$	65
		$T_C=100^\circ\text{C}$	26
P_{DSM}	Power Dissipation ^a	$T_A=25^\circ\text{C}$	3
		$T_A=70^\circ\text{C}$	2
I_{AS}	Avalanche Current ^b L=0.5mH Single Pulse	35	A
E_{AS}	Avalanche Energy ^b L=0.5mH Single Pulse	306	mJ
T_J	Operation junction temperature	-55~150	°C
T_{STG}	Storage temperature range	-55~150	

➤ **Thermal Resistance Ratings ($T_A=25^\circ\text{C}$ unless otherwise noted)**

Symbol	Parameter	Ratings	Unit
$R_{\theta JA}$	Junction-to-Ambient Thermal Resistance ^a	40	°C/W
$R_{\theta JC}$	Junction-to-Case Thermal Resistance	1.9	

Note:

- The value of $R_{\theta JA}$ is measured with the device mounted on 1 in² FR-4 board with 2oz.copper, in a still air environment with $T_A=25^\circ\text{C}$. The value in any given application depends on the user is specific board design. The power dissipation is based on the $t \leq 10\text{s}$ thermal resistance rating.
- Repetitive rating, pulse width limited by junction temperature.
- The power dissipation P_D is based on $T_{J(MAX)}=150^\circ\text{C}$, using junction-to-case thermal resistance, and is more useful in setting the upper dissipation limit for cases where additional heat sinking is used.
- The maximum current rating is package limited.



➤ **Electrical Characteristics (T_A=25°C unless otherwise noted)**

Parameter	Symbol	Test Conditions	Min.	Typ.	Max.	Unit
Drain-Source Breakdown Voltage	V _{(BR)DSS}	V _{GS} = 0V, I _D = -250μA	-100			V
Gate Threshold Voltage	V _{GS(th)}	V _{DS} = V _{GS} , I _D = -250μA	-1.0	-2.0	-3.0	V
Drain-Source On-Resistance	R _{DS(on)}	V _{GS} = -10V, I _D = -15A		35	51	mΩ
		V _{GS} = -4.5V, I _D = -10A		40	68	
Zero Gate Voltage Drain Current	I _{DSS}	V _{DS} = -100V, V _{GS} = 0V			-1	μA
Gate-Source Leak Current	I _{GSS}	V _{GS} = ±20V, V _{DS} = 0V			±100	nA
Forward Voltage	V _{SD}	V _{GS} = 0V, I _S = -10A		-0.8	-1.4	V
Gate Resistance	R _G	V _{DS} = 0V, f = 1MHz		12.5		Ω
Input Capacitance	C _{ISS}	V _{DS} = -50V, V _{GS} = 0V, f = 1MHz		4560		pF
Output Capacitance	C _{OSS}			229		
Reverse Transfer Capacitance	C _{RSS}			140		
Total Gate Charge	Q _G	V _{GS} = -10V, V _{DS} = -50V, I _D = -15A		77		nC
Gate to Source Charge	Q _{GS}			22		
Gate to Drain Charge	Q _{GD}			14		
Turn-on Delay Time	T _{D(ON)}	V _{GS} = -10V, V _{DS} = -50V, R _L = 3.3Ω, R _G = 9.1Ω		11		ns
Rise Time	T _r			43		
Turn-off Delay Time	T _{D(OFF)}			251		
Fall Time	T _f			88		
Diode Recovery Time	T _{rr}	I _F = -20A, di/dt = 100A/us		35		ns
Diode Recovery Charge	Q _{rr}	I _F = -20A, di/dt = 100A/us		52		nC



➤ **Typical Performance Characteristics ($T_A=25^\circ\text{C}$ unless otherwise noted)**

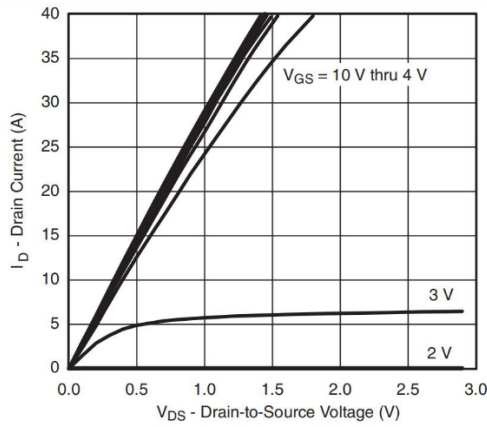

Output Characteristics

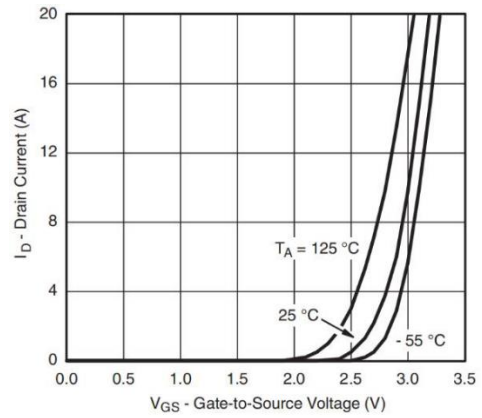

Transfer Characteristics

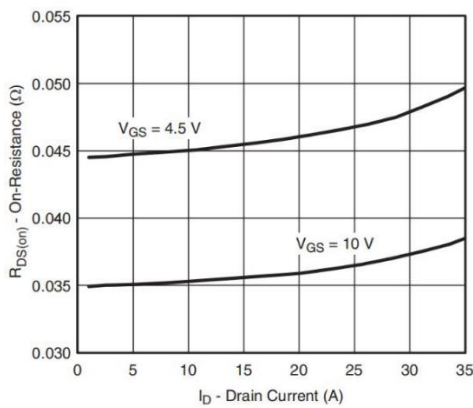

On-Resistance vs. Drain Current and Gate Voltage

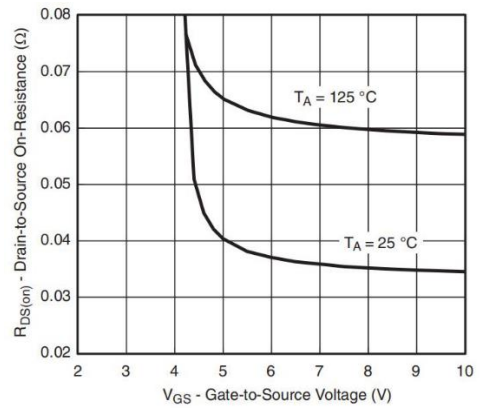

On-Resistance vs. Gate-to-Source Voltage

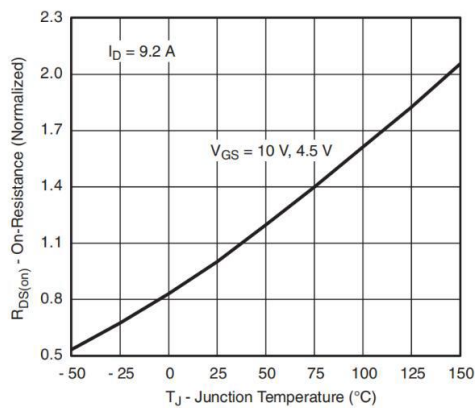

On-Resistance vs. Junction Temperature

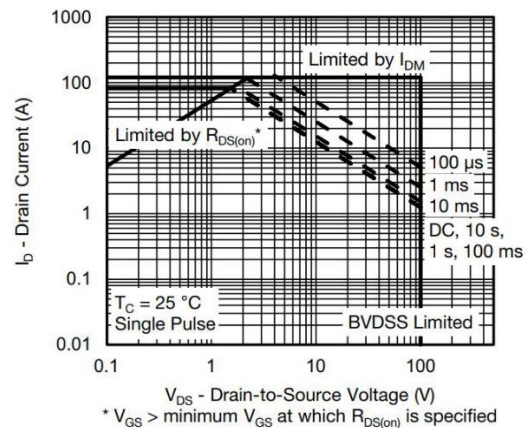

Safe Operating Area



➤ Package Information

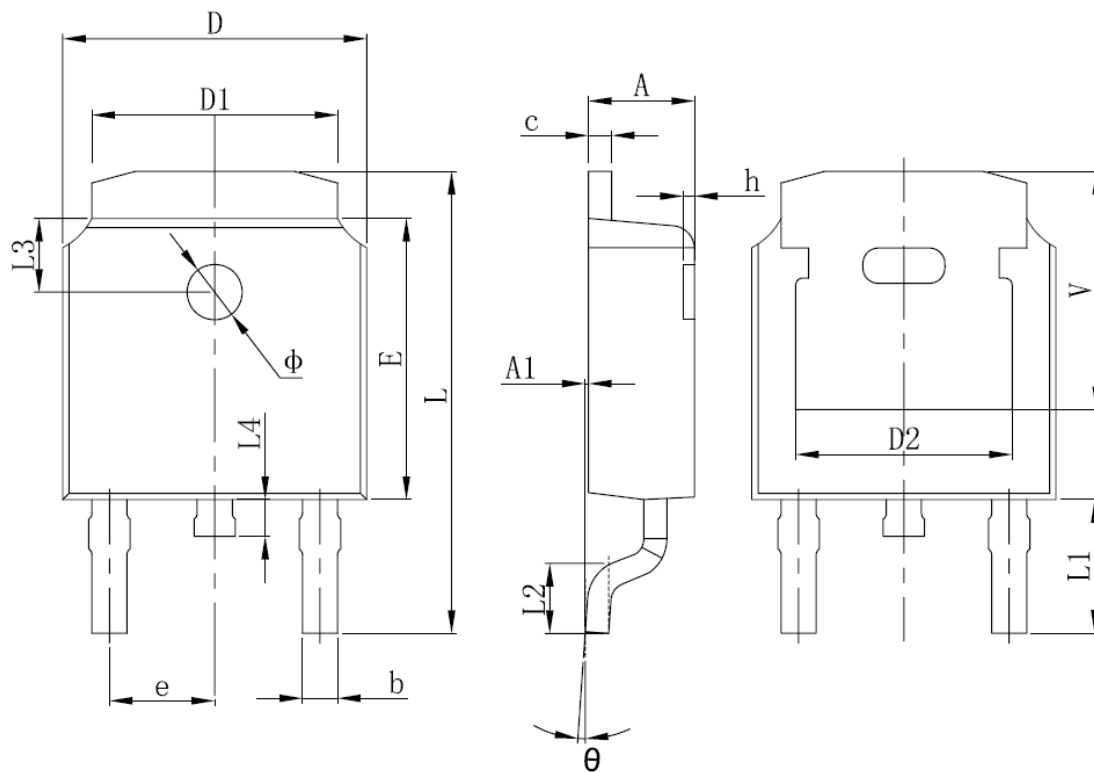

Symbol	Dimensions In Millimeters		Dimensions In Inches	
	Min.	Max.	Min.	Max.
A	2.200	2.400	0.087	0.094
A1	0.000	0.127	0.000	0.005
b	0.635	0.770	0.025	0.030
c	0.460	0.580	0.018	0.023
D	6.500	6.700	0.256	0.264
D1	5.100	5.460	0.201	0.215
D2	4.830 REF.		0.190 REF.	
E	6.000	6.200	0.236	0.244
e	2.186	2.386	0.086	0.094
L	9.712	10.312	0.382	0.406
L1	2.900 REF.		0.114 REF.	
L2	1.400	1.700	0.055	0.067
L3	1.600 REF.		0.063 REF.	
L4	0.600	1.000	0.024	0.039
Φ	1.100	1.300	0.043	0.051
θ	0°	8°	0°	8°
h	0.000	0.300	0.000	0.012
V	5.250 REF.		0.207 REF.	



➤ Tape and Reel

材质: PS 未标注公差: ± 0.2

H	12	16	24	32
C ± 0.2	330	330	330	330
T1 ± 0.2	1.45	1.45	1.45	1.45
B ± 0.2	10.7	10.7	10.7	10.7
A ± 0.2	2.5	2.5	2.5	2.5
T ± 0.2	1.85	1.85	1.85	1.85
D ± 0.2	100	100	100	100

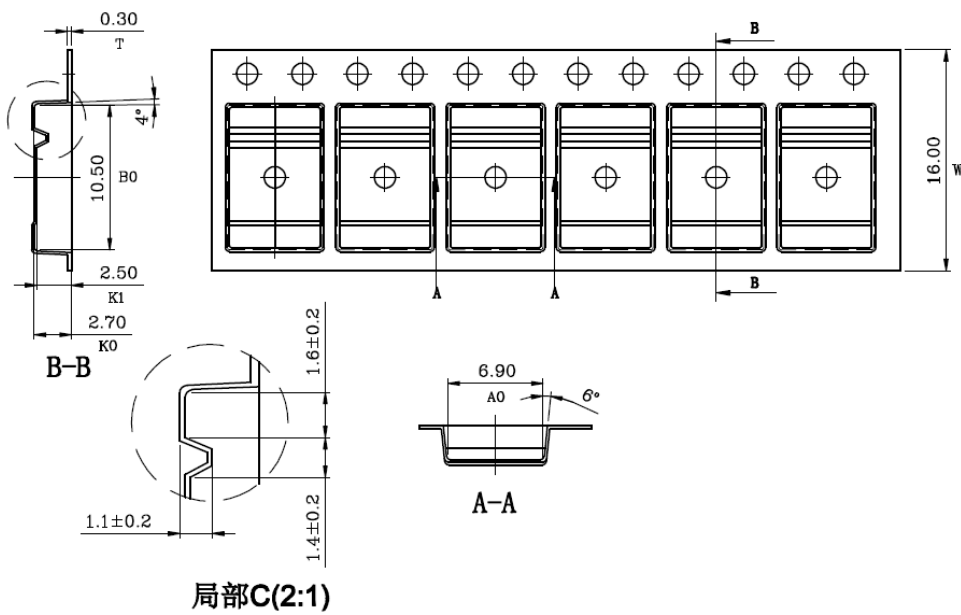
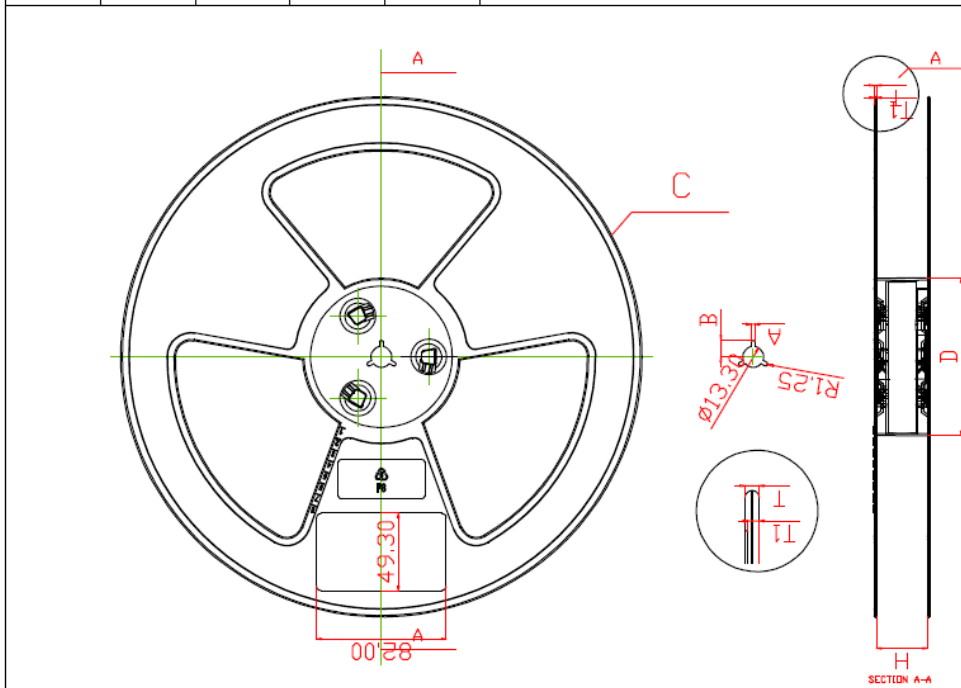



DISCLAIMER

AFSEMI RESERVES THE RIGHT TO MAKE CHANGES WITHOUT FURTHER NOTICE TO ANY PRODUCTS HEREIN TO IMPROVE RELIABILITY, FUNCTION OR DESIGN. AFSEMI DOES NOT ASSUME ANY LIABILITY ARISING OUT OF THE APPLICATION OR USE OF ANY PRODUCT OR CIRCUIT DESCRIBED HEREIN; NEITHER DOES IT CONVEY ANY LICIENCE UNDER ITS PATENT RIGHTS, NOR THE RIGHTS OF OTHERS.

THE GRAPHS PROVIDED IN THIS DOCUMENT ARE STATISTICAL SUMMARIES BASED ON A LIMITED NUMBER OF SAMPLES AND ARE PROVIDED FOR INFORMATIONAL PURPOSE ONLY. THE PERFORMANCE CHARACTERISTICS LISTED IN THEM ARE NOT TESTED OR GUARANTEED. IN SOME GRAPHS, THE DATA PRESENTED MAY BE OUTSIDE THE SPECIFIED OPERATING RANGE (E.G. OUTSIDE SPECIFIED POWER SUPPLY RANGE) AND THEREFORE OUTSIDE THE WARRANTED RANGE.

OUR PRODUCT SPECIFICATIONS ARE ONLY VALID IF OBTAINED THROUGH THE COMPANY'S OFFICIAL WEBSITE, CRM SYSTEM, OR OUR SALES PERSONNEL CHANNELS. IF CHANGES OR SPECIAL VERSIONS ARE INVOLVED, THEY MUST BE STAMPED WITH A QUALITY SEAL AND MARKED WITH A SPECIAL VERSION NUMBER TO BE VALID.